

# Low Solids Silicone

## Table of Contents

<b>Detail, Foam Stop, Interior Drain Roofs</b>	Detail Drawings	English	<b>2</b>
<b>Detail, Parapet Wall</b>	Detail Drawings	English	<b>3</b>
<b>Detail, Gravel Stop</b>	Detail Drawings	English	<b>4</b>
<b>Detail, Roof Drain</b>	Detail Drawings	English	<b>5</b>
<b>Detail, Roof Vent</b>	Detail Drawings	English	<b>6</b>
<b>Detail, Vertical Projection</b>	Detail Drawings	English	<b>7</b>
<b>Detail, Concrete Roof, Crack Treatment</b>	Detail Drawings	English	<b>8</b>
<b>Detail, Concrete Roof, Drain</b>	Detail Drawings	English	<b>9</b>
<b>Detail, Concrete Roof, Parapet</b>	Detail Drawings	English	<b>10</b>
<b>Detail, Concrete Roof, Pipe Penetration</b>	Detail Drawings	English	<b>11</b>
<b>Detail, Modified Bitumen Roof, Drain</b>	Detail Drawings	English	<b>12</b>
<b>Detail, Modified Bitumen Roof, Edge</b>	Detail Drawings	English	<b>13</b>
<b>Detail, Modified Bitumen Roof, Pipe Penetration</b>	Detail Drawings	English	<b>14</b>
<b>Detail, Modified Bitumen Roof, Seam Treatment</b>	Detail Drawings	English	<b>15</b>
<b>Detail, Single Ply Roof, Drain</b>	Detail Drawings	English	<b>16</b>
<b>Detail, Single Ply Roof, Edge</b>	Detail Drawings	English	<b>17</b>
<b>Detail, Single Ply Roof, Pipe Penetration</b>	Detail Drawings	English	<b>18</b>
<b>Detail, Single Ply Roof, Seam Treatment</b>	Detail Drawings	English	<b>19</b>

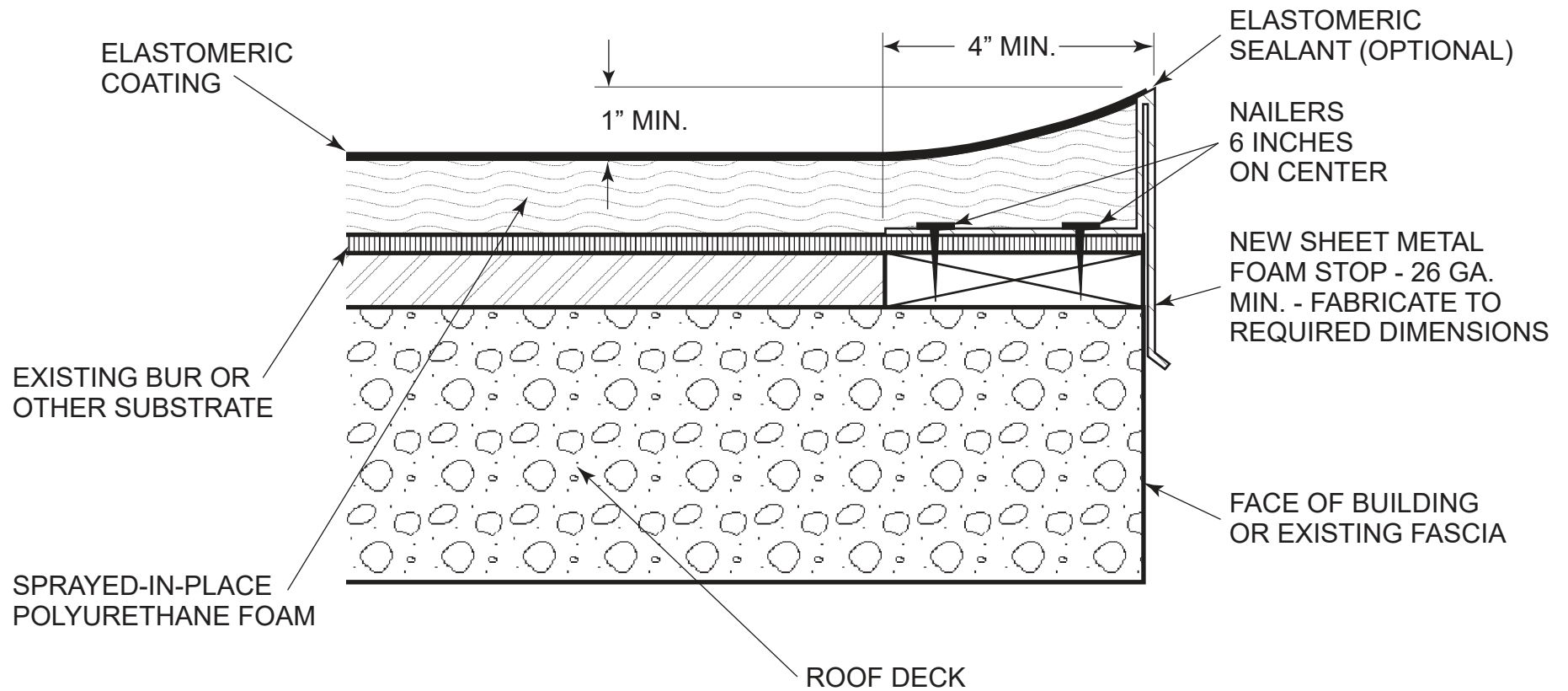

Note: This detail is utilized in the specification and design of fluid-applied roofing, in both new and retrofit applications. It is provided to show a generally recommended procedure for dealing with the condition shown. It will not and cannot provide a specific solution for every condition likely to be encountered in field application. Where field conditions differ, the use of applicable portions of the detail shown or its adaptation by an experienced and conscientious applicator should result in a quality project.



2728 Empire Central  
Dallas, Texas 75236  
(214)-353-1600  
www.neogard.com

Project:

Foam Stop, Interior Drain Roofs

Drawn by:  
K. Kirby

Scale:  
NTS

Date:  
04/01/2020

Drawing/Index No.  
ROOF\_foam-stop-interior-drain-04012020

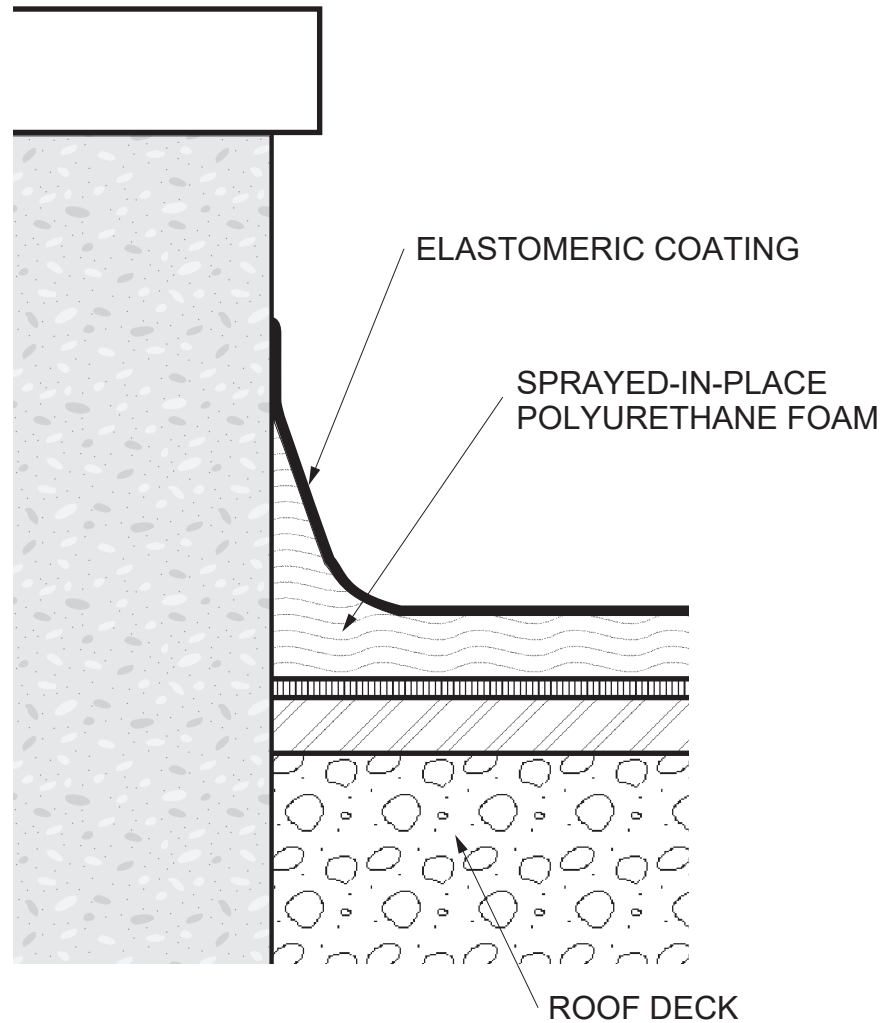

Note: This detail is utilized in the specification and design of fluid-applied roofing, in both new and retrofit applications. It is provided to show a generally recommended procedure for dealing with the condition shown. It will not and cannot provide a specific solution for every condition likely to be encountered in field application. Where field conditions differ, the use of applicable portions of the detail shown or its adaptation by an experienced and conscientious applicator should result in a quality project.



2728 Empire Central  
 Dallas, Texas 75236  
 (214)-353-1600  
 www.neogard.com

Project:  
 Roof Parapet Wall

Drawn by: K. Kirby	Scale: NTS	Date: 04/01/2020	Drawing/Index No. ROOF_parapet-wall-04012020
-----------------------	---------------	---------------------	---

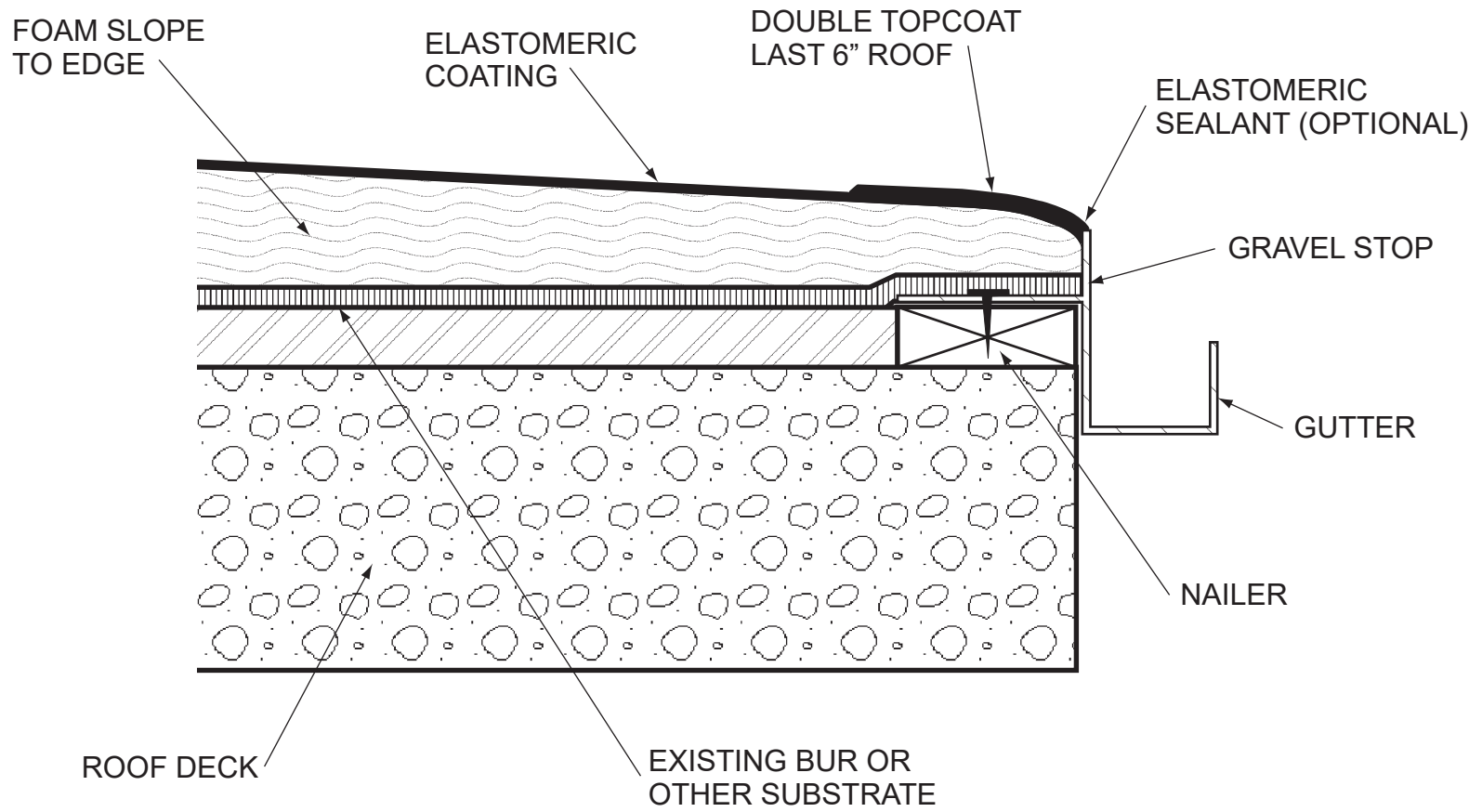

Note: This detail is utilized in the specification and design of fluid-applied roofing, in both new and retrofit applications. It is provided to show a generally recommended procedure for dealing with the condition shown. It will not and cannot provide a specific solution for every condition likely to be encountered in field application. Where field conditions differ, the use of applicable portions of the detail shown or its adaptation by an experienced and conscientious applicator should result in a quality project.



2728 Empire Central  
 Dallas, Texas 75236  
 (214)-353-1600  
 www.neogard.com

Project:  
 Gravel Stop

Drawn by: K. Kirby	Scale: NTS	Date: 04/01/2020	Drawing/Index No. ROOF_gravel-stop-04012020
-----------------------	---------------	---------------------	--

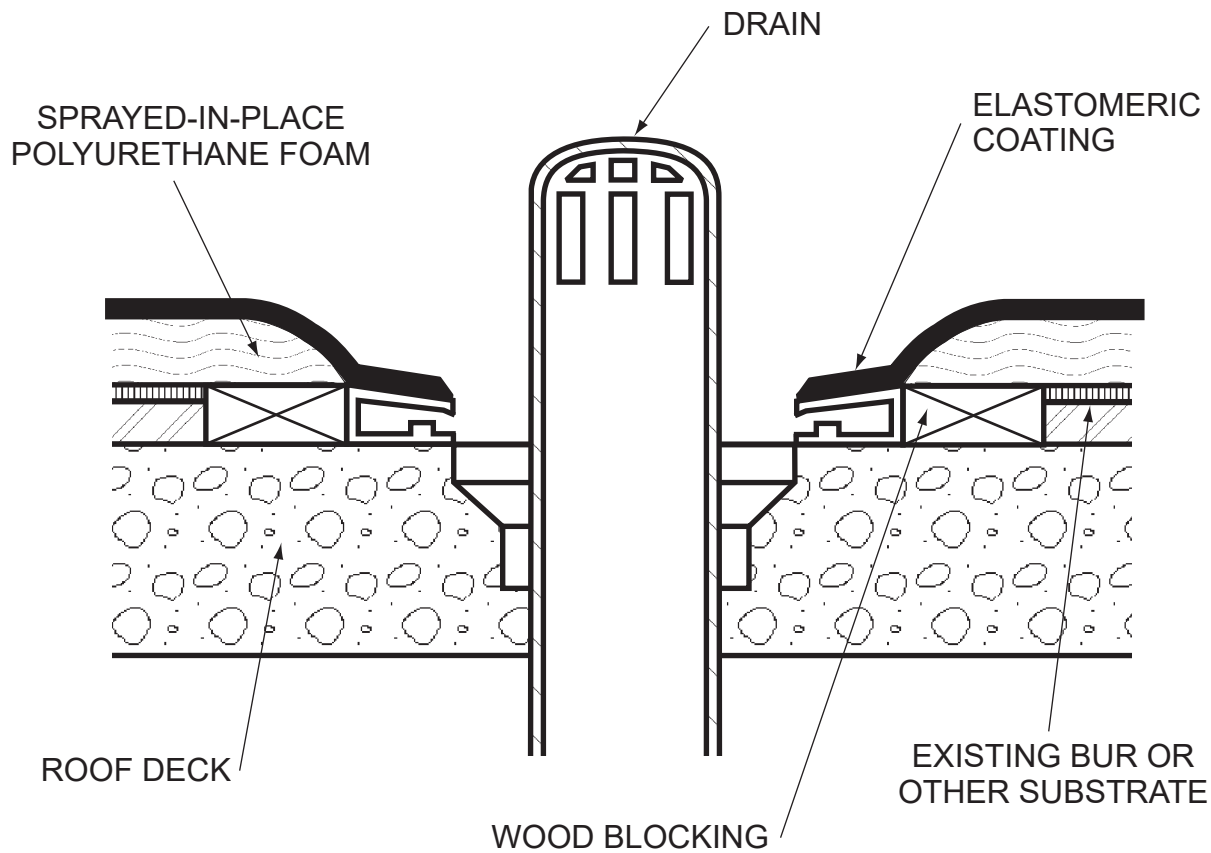

Note: This detail is utilized in the specification and design of fluid-applied roofing, in both new and retrofit applications. It is provided to show a generally recommended procedure for dealing with the condition shown. It will not and cannot provide a specific solution for every condition likely to be encountered in field application. Where field conditions differ, the use of applicable portions of the detail shown or its adaptation by an experienced and conscientious applicator should result in a quality project.



2728 Empire Central  
 Dallas, Texas 75236  
 (214)-353-1600  
 www.neogard.com

Project:  
 Roof Drain

Drawn by: K. Kirby	Scale: NTS	Date: 04/01/2020	Drawing/Index No. ROOF_spf-drain-04012020
-----------------------	---------------	---------------------	--

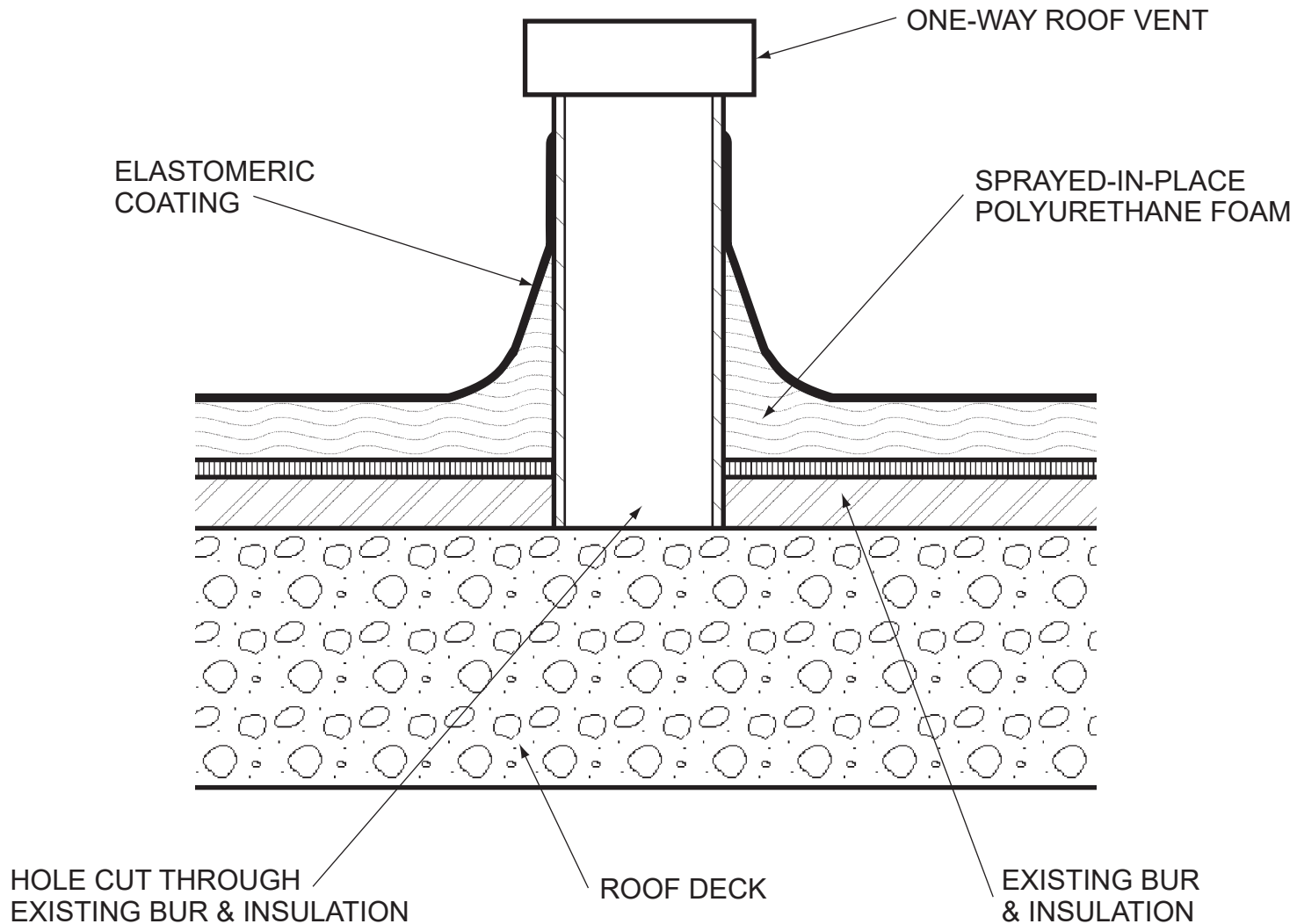

Note: This detail is utilized in the specification and design of fluid-applied roofing, in both new and retrofit applications. It is provided to show a generally recommended procedure for dealing with the condition shown. It will not and cannot provide a specific solution for every condition likely to be encountered in field application. Where field conditions differ, the use of applicable portions of the detail shown or its adaptation by an experienced and conscientious applicator should result in a quality project.



2728 Empire Central  
 Dallas, Texas 75236  
 (214)-353-1600  
 www.neogard.com

Project:  
 Roof Vent

Drawn by:  
 K. Kirby

Scale:  
 NTS

Date:  
 04/01/2020

Drawing/Index No.  
 ROOF\_vent-04012020

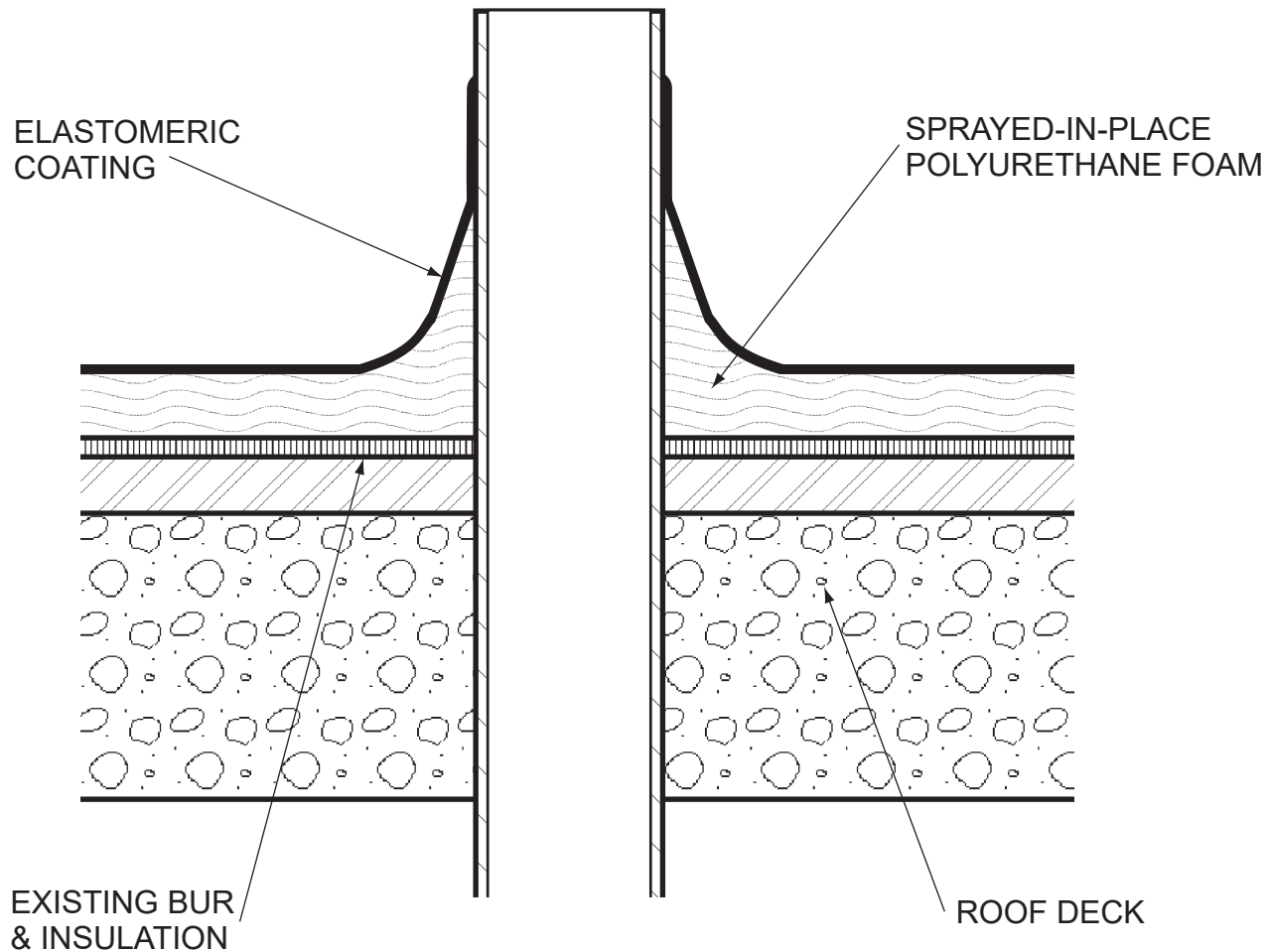

Note: This detail is utilized in the specification and design of fluid-applied roofing, in both new and retrofit applications. It is provided to show a generally recommended procedure for dealing with the condition shown. It will not and cannot provide a specific solution for every condition likely to be encountered in field application. Where field conditions differ, the use of applicable portions of the detail shown or its adaptation by an experienced and conscientious applicator should result in a quality project.



2728 Empire Central  
 Dallas, Texas 75236  
 (214)-353-1600  
 www.neogard.com

Project:  
 Vertical Projection

Drawn by: K. Kirby	Scale: NTS	Date: 04/01/2020	Drawing/Index No. ROOF_vert-proj-04012020
-----------------------	---------------	---------------------	--

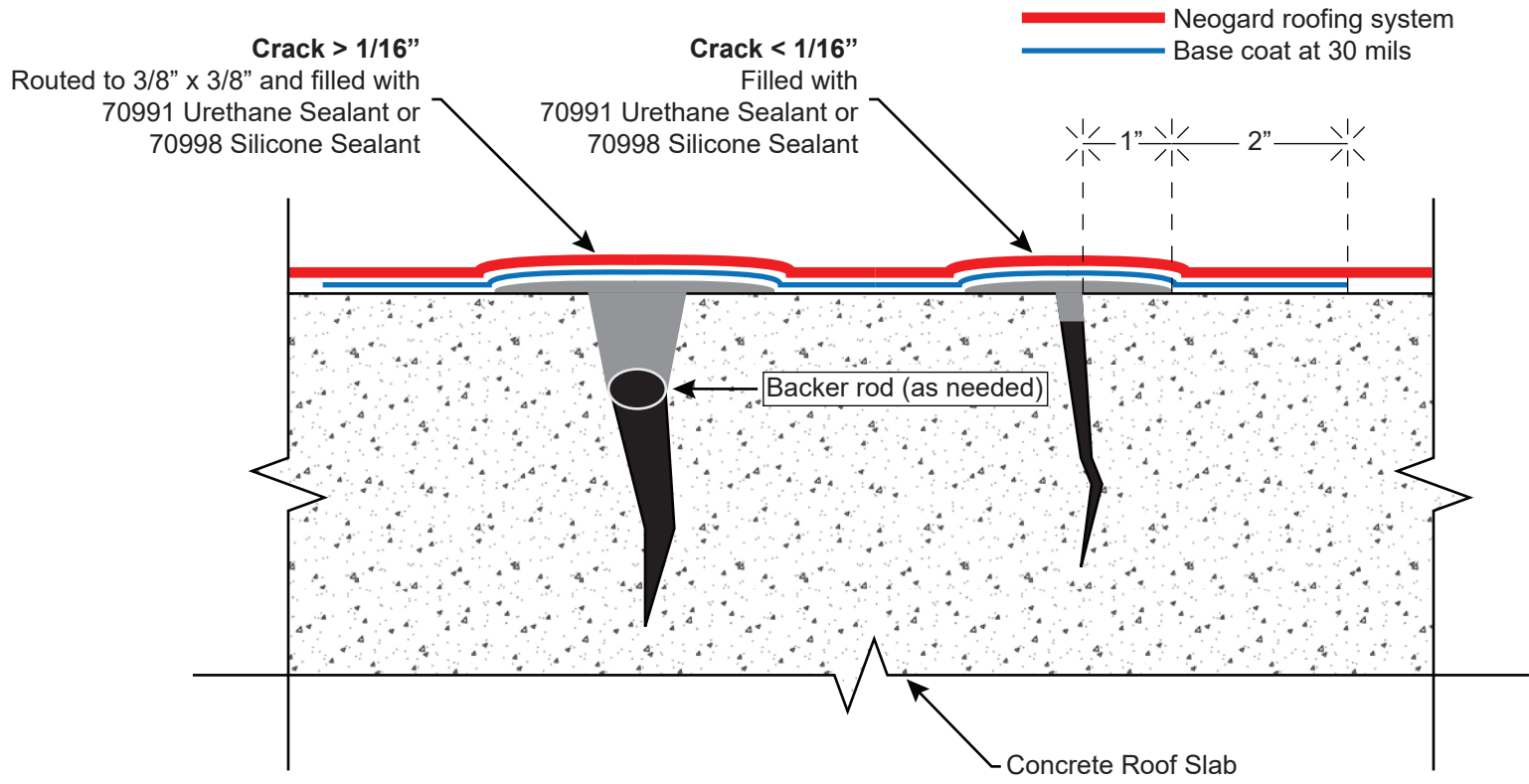

Note: This detail is utilized in the specification and design of fluid-applied roofing, in both new and retrofit applications. It is provided to show a generally recommended procedure for dealing with the condition shown. It will not and cannot provide a specific solution for every condition likely to be encountered in field application. Where field conditions differ, the use of applicable portions of the detail shown or its adaptation by an experienced and conscientious applicator should result in a quality project.



2728 Empire Central  
Dallas, Texas 75236  
(214)-353-1600  
www.neogard.com

Project:  
Crack Treatment, Concrete Substrate

Drawn by: KSK	Scale: NTS	Date: 08/16/2021	Drawing/Index No. ROOF-C_cracks-08162021
------------------	---------------	---------------------	---



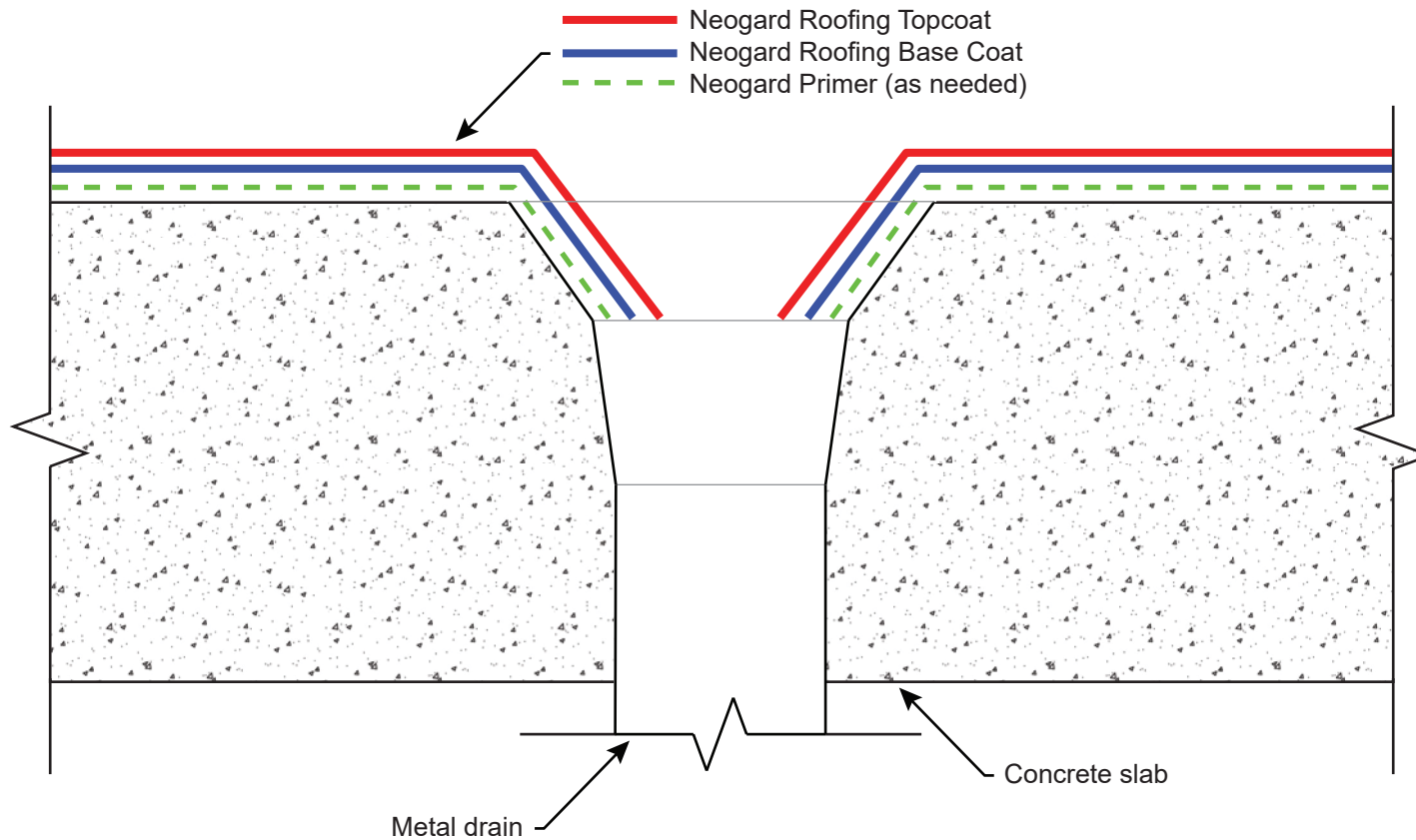

Note: This detail is utilized in the specification and design of fluid-applied roofing, in both new and retrofit applications. It is provided to show a generally recommended procedure for dealing with the condition shown. It will not and cannot provide a specific solution for every condition likely to be encountered in field application. Where field conditions differ, the use of applicable portions of the detail shown or its adaptation by an experienced and conscientious applicator should result in a quality project.



2728 Empire Central  
Dallas, Texas 75236  
(214)-353-1600  
www.neogard.com

Project:

Drain Detail, Concrete Substrate

Drawn by:

KSK

Scale:

NTS

Date:

08/16/2021

Drawing/Index No.

ROOF-C\_drain-08162021

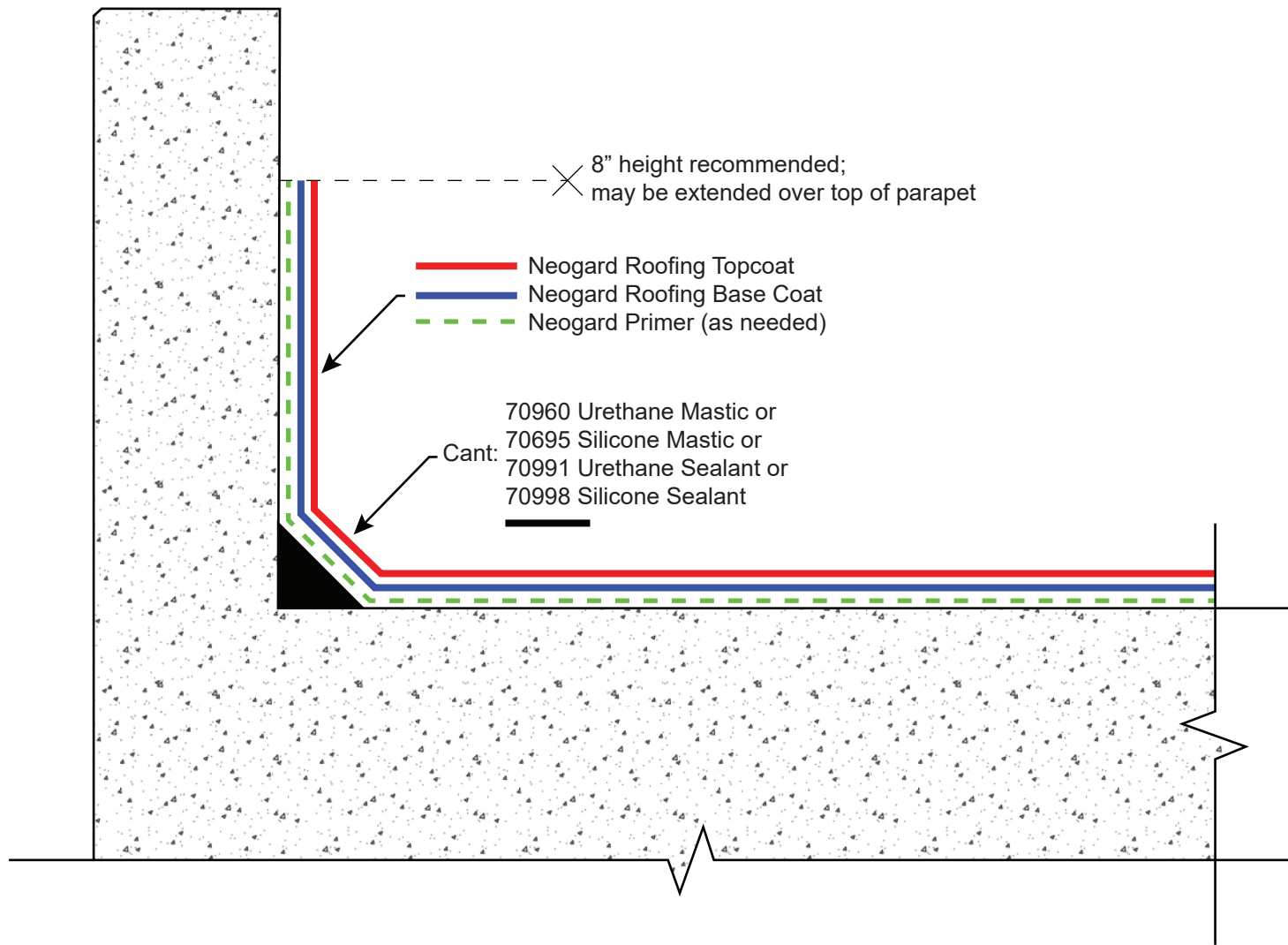

Note: This detail is utilized in the specification and design of fluid-applied roofing, in both new and retrofit applications. It is provided to show a generally recommended procedure for dealing with the condition shown. It will not and cannot provide a specific solution for every condition likely to be encountered in field application. Where field conditions differ, the use of applicable portions of the detail shown or its adaptation by an experienced and conscientious applicator should result in a quality project.



2728 Empire Central  
Dallas, Texas 75236  
(214)-353-1600  
www.neogard.com

Project:

Roof Parapet, Concrete Substrate

Drawn by:

KSK

Scale:

NTS

Date:

08/16/2021

Drawing/Index No.

ROOF-C\_parapet-08162021

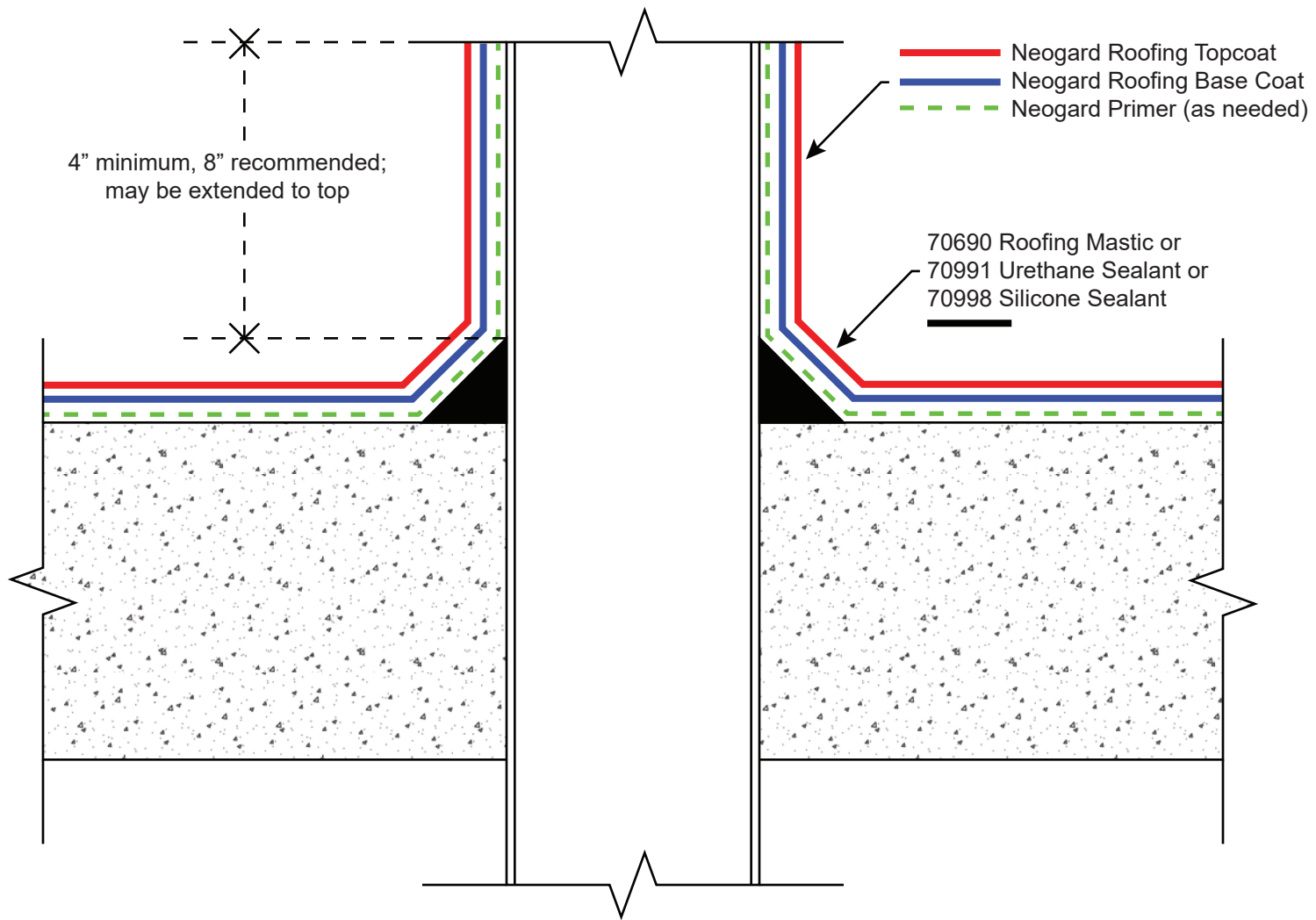

Note: This detail is utilized in the specification and design of fluid-applied roofing, in both new and retrofit applications. It is provided to show a generally recommended procedure for dealing with the condition shown. It will not and cannot provide a specific solution for every condition likely to be encountered in field application. Where field conditions differ, the use of applicable portions of the detail shown or its adaptation by an experienced and conscientious applicator should result in a quality project.



2728 Empire Central  
Dallas, Texas 75236  
(214)-353-1600  
www.neogard.com

Project:

Pipe Penetration, Concrete Substrate

Drawn by:

KSK

Scale:

NTS

Date:

08/20/2021

Drawing/Index No.

ROOF-C\_pipe-08202021

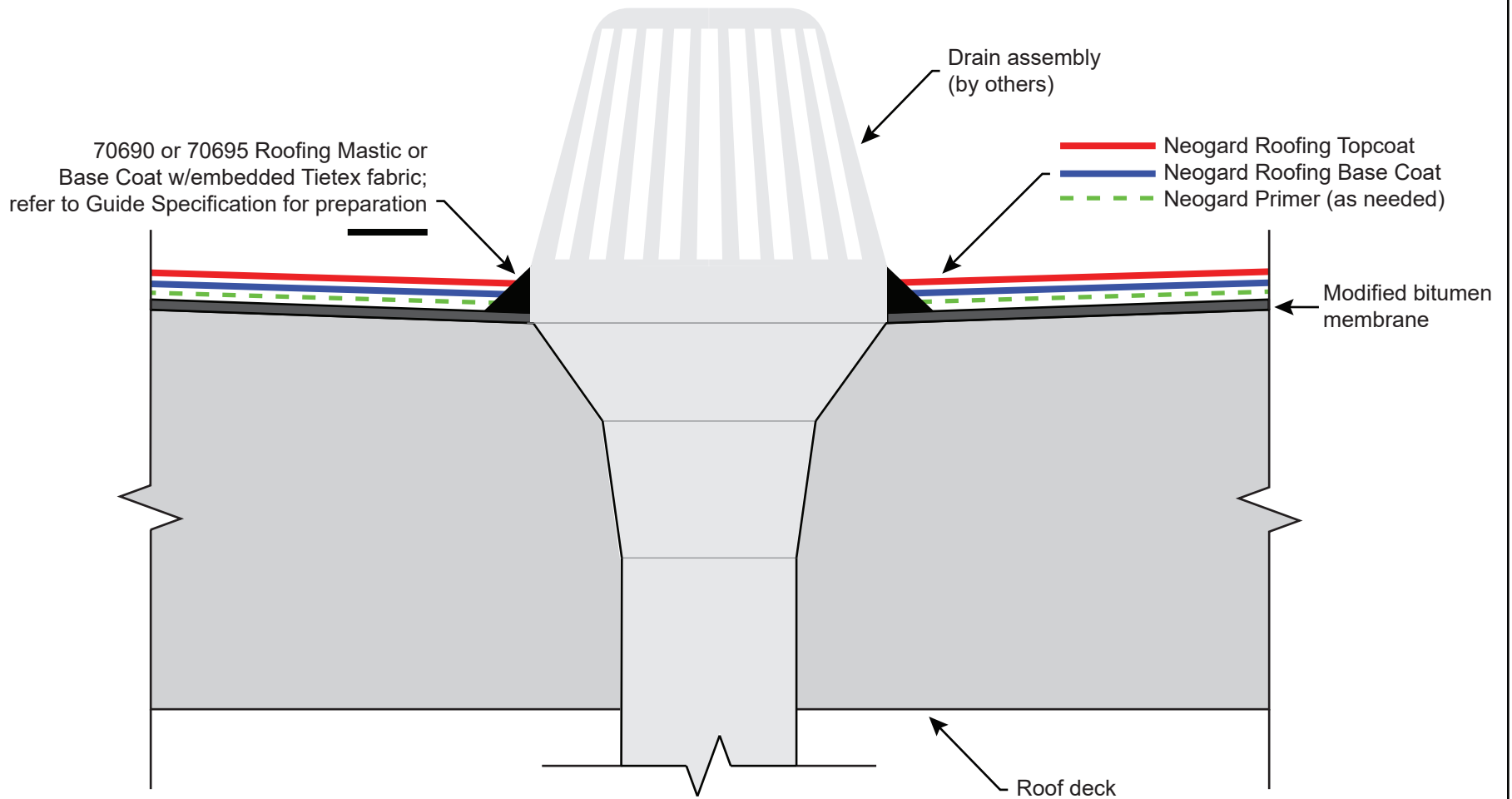

Note: This detail is utilized in the specification and design of fluid-applied roofing, in both new and retrofit applications. It is provided to show a generally recommended procedure for dealing with the condition shown. It will not and cannot provide a specific solution for every condition likely to be encountered in field application. Where field conditions differ, the use of applicable portions of the detail shown or its adaptation by an experienced and conscientious applicator should result in a quality project.



2728 Empire Central  
 Dallas, Texas 75236  
 (214)-353-1600  
 www.neogard.com

Project:

Drain Detail, Modified Bitumen Substrate

Drawn by:

KSK

Scale:

NTS

Date:

08/20/2021

Drawing/Index No.

ROOF-MB\_drain-08202021

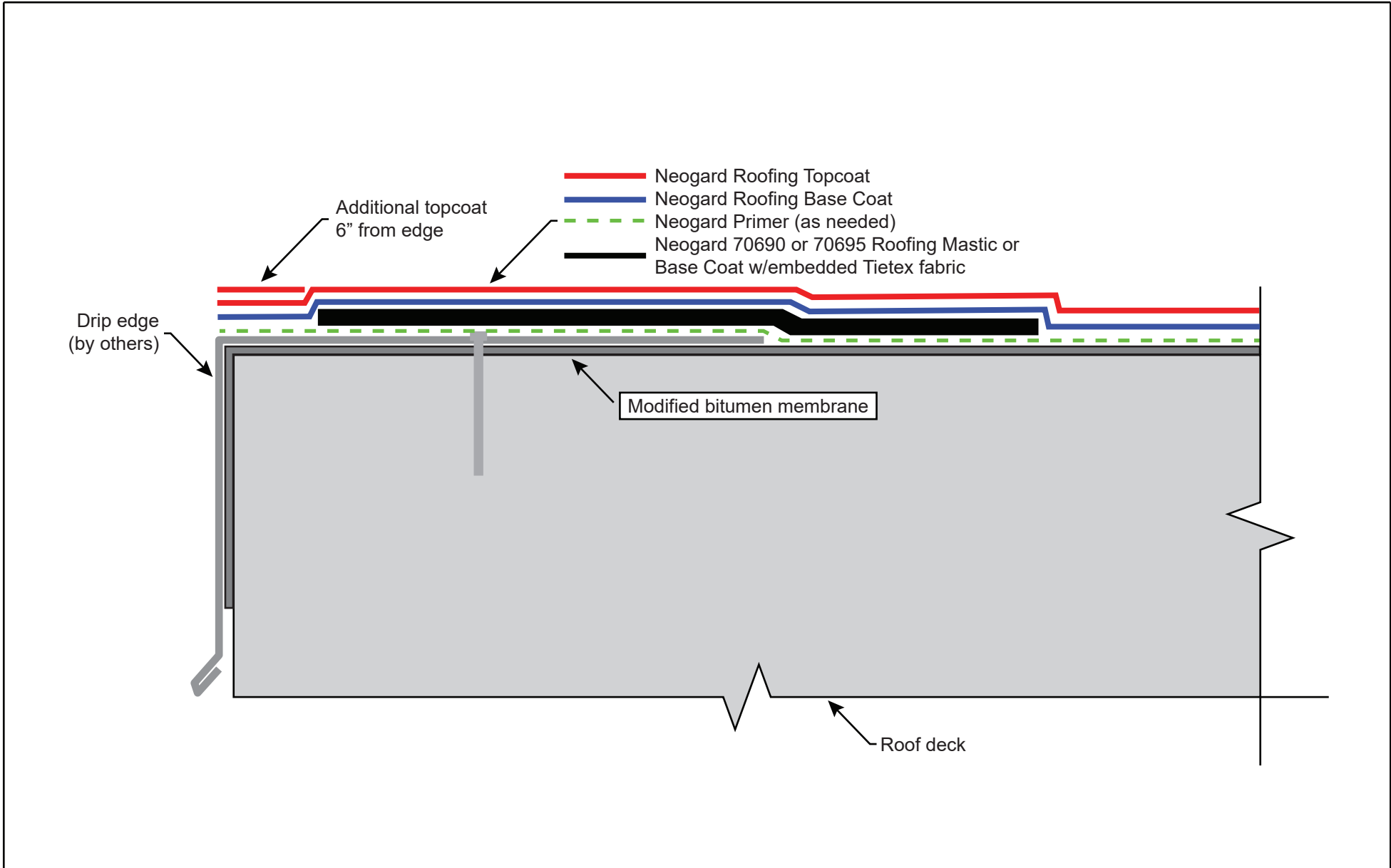

Note: This detail is utilized in the specification and design of fluid-applied roofing, in both new and retrofit applications. It is provided to show a generally recommended procedure for dealing with the condition shown. It will not and cannot provide a specific solution for every condition likely to be encountered in field application. Where field conditions differ, the use of applicable portions of the detail shown or its adaptation by an experienced and conscientious applicator should result in a quality project.



2728 Empire Central  
 Dallas, Texas 75236  
 (214)-353-1600  
 www.neogard.com

Project:  
 Edge Detail, Modified Bitumen Substrate

Drawn by: KSK	Scale: NTS	Date: 08/20/2021	Drawing/Index No. ROOF-MB_edge-08202021
------------------	---------------	---------------------	--

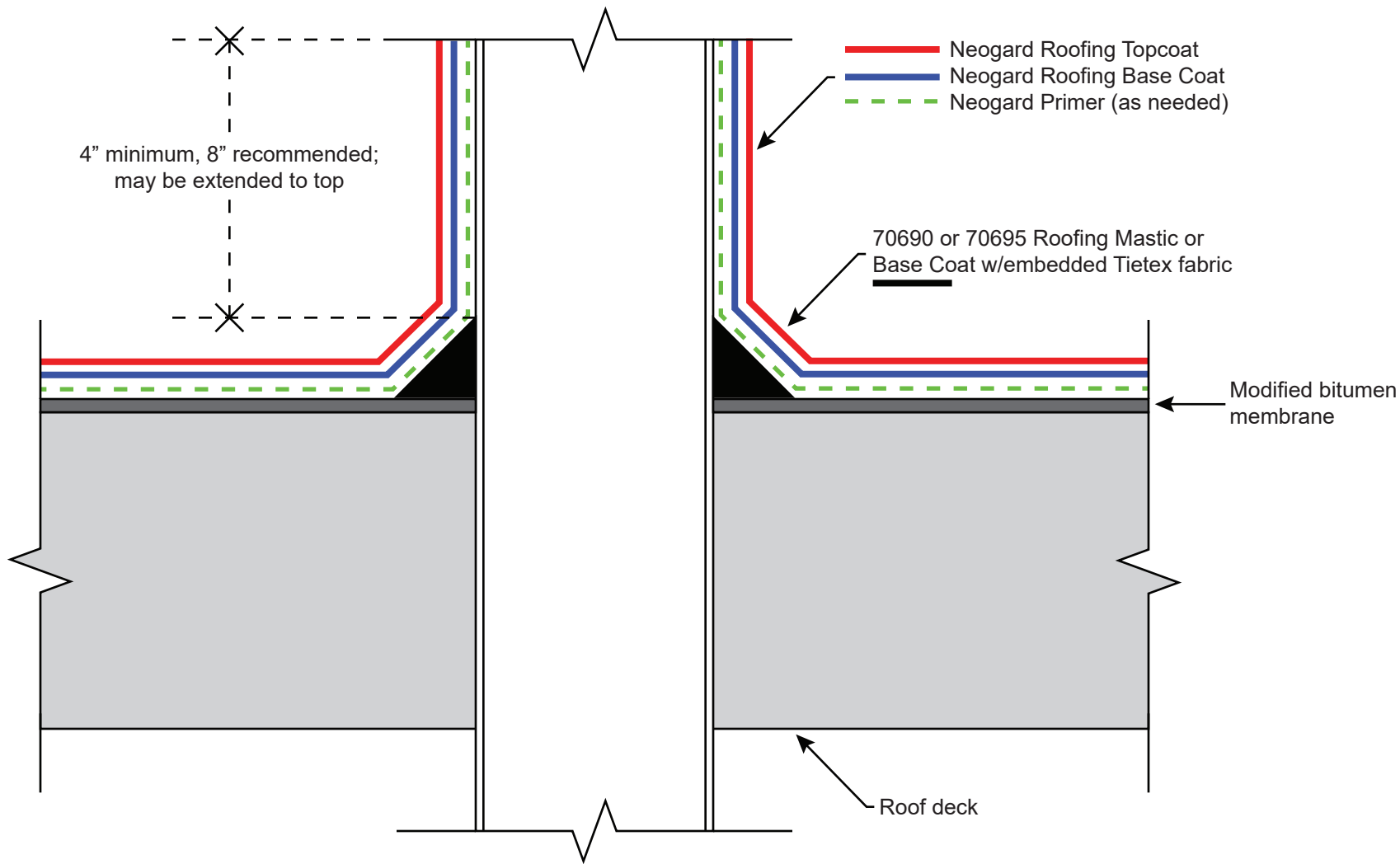

Note: This detail is utilized in the specification and design of fluid-applied roofing, in both new and retrofit applications. It is provided to show a generally recommended procedure for dealing with the condition shown. It will not and cannot provide a specific solution for every condition likely to be encountered in field application. Where field conditions differ, the use of applicable portions of the detail shown or its adaptation by an experienced and conscientious applicator should result in a quality project.



2728 Empire Central  
 Dallas, Texas 75236  
 (214)-353-1600  
 www.neogard.com

Project:  
 Pipe Penetration, Modified Bitumen Substrate

Drawn by:	Scale:	Date:	Drawing/Index No.
KSK	NTS	08/20/2021	ROOF-MB_pipe-08202021

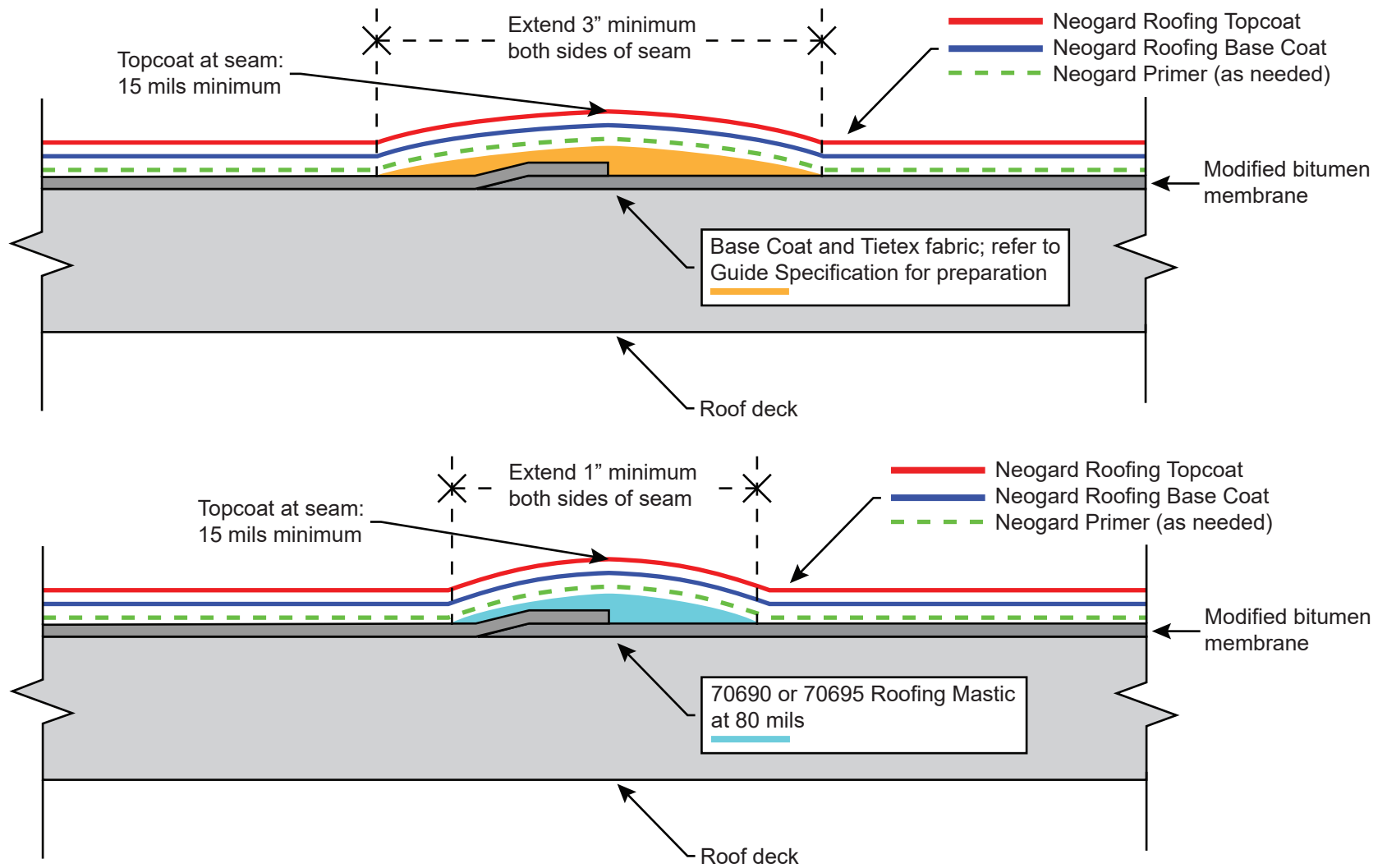

Note: This detail is utilized in the specification and design of fluid-applied roofing, in both new and retrofit applications. It is provided to show a generally recommended procedure for dealing with the condition shown. It will not and cannot provide a specific solution for every condition likely to be encountered in field application. Where field conditions differ, the use of applicable portions of the detail shown or its adaptation by an experienced and conscientious applicator should result in a quality project.



2728 Empire Central  
Dallas, Texas 75236  
(214)-353-1600  
www.neogard.com

Project:

Seam Detail, Modified Bitumen Substrate

Drawn by:

KSK

Scale:

NTS

Date:

08/20/2021

Drawing/Index No.

ROOF-MB\_seam-08202021

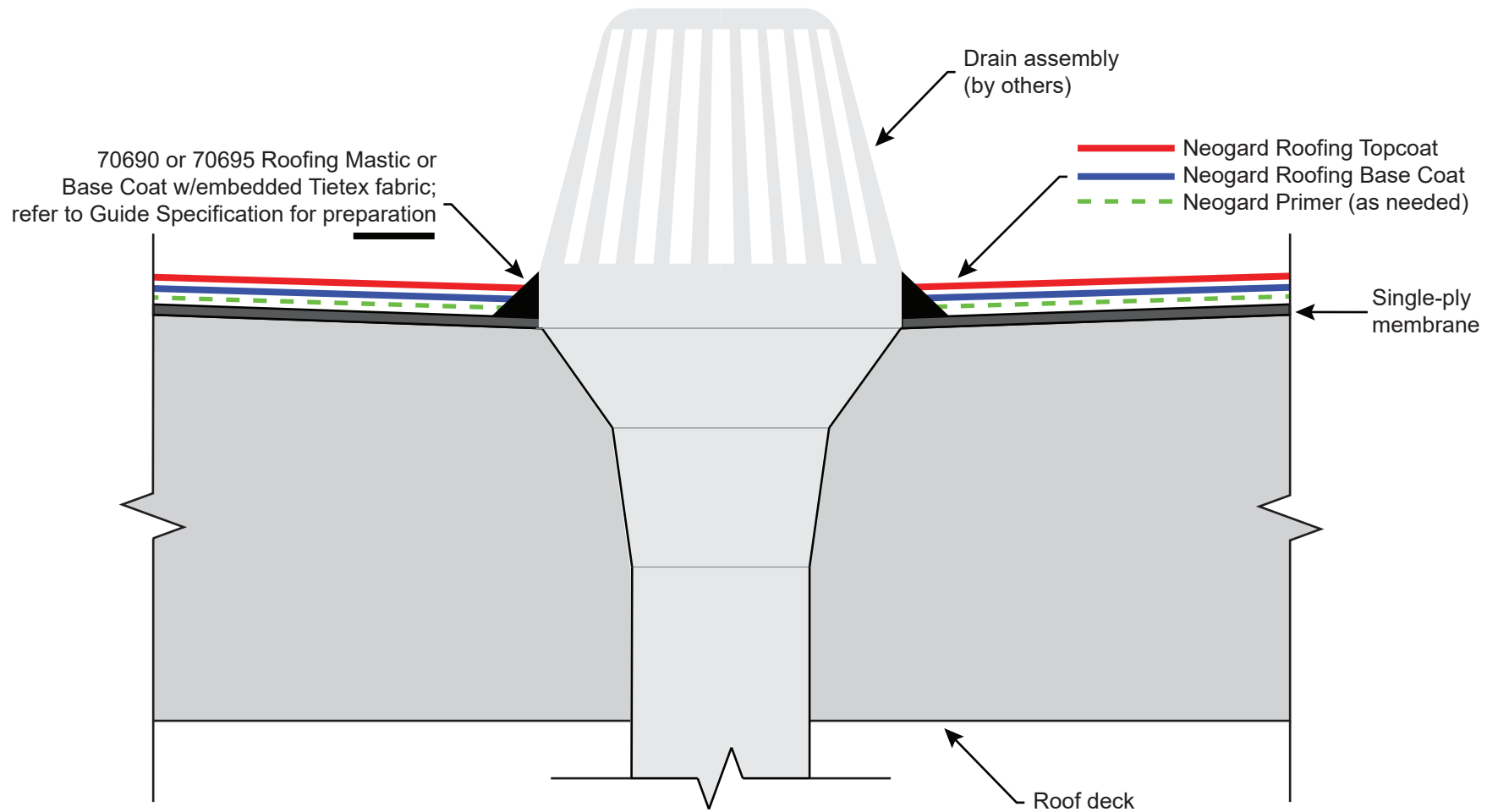

Note: This detail is utilized in the specification and design of fluid-applied roofing, in both new and retrofit applications. It is provided to show a generally recommended procedure for dealing with the condition shown. It will not and cannot provide a specific solution for every condition likely to be encountered in field application. Where field conditions differ, the use of applicable portions of the detail shown or its adaptation by an experienced and conscientious applicator should result in a quality project.



2728 Empire Central  
Dallas, Texas 75236  
(214)-353-1600  
www.neogard.com

Project:

Drain Detail, Single Ply Substrate

Drawn by:

KSK

Scale:

NTS

Date:

08/20/2021

Drawing/Index No.

ROOF-SP\_drain-08202021



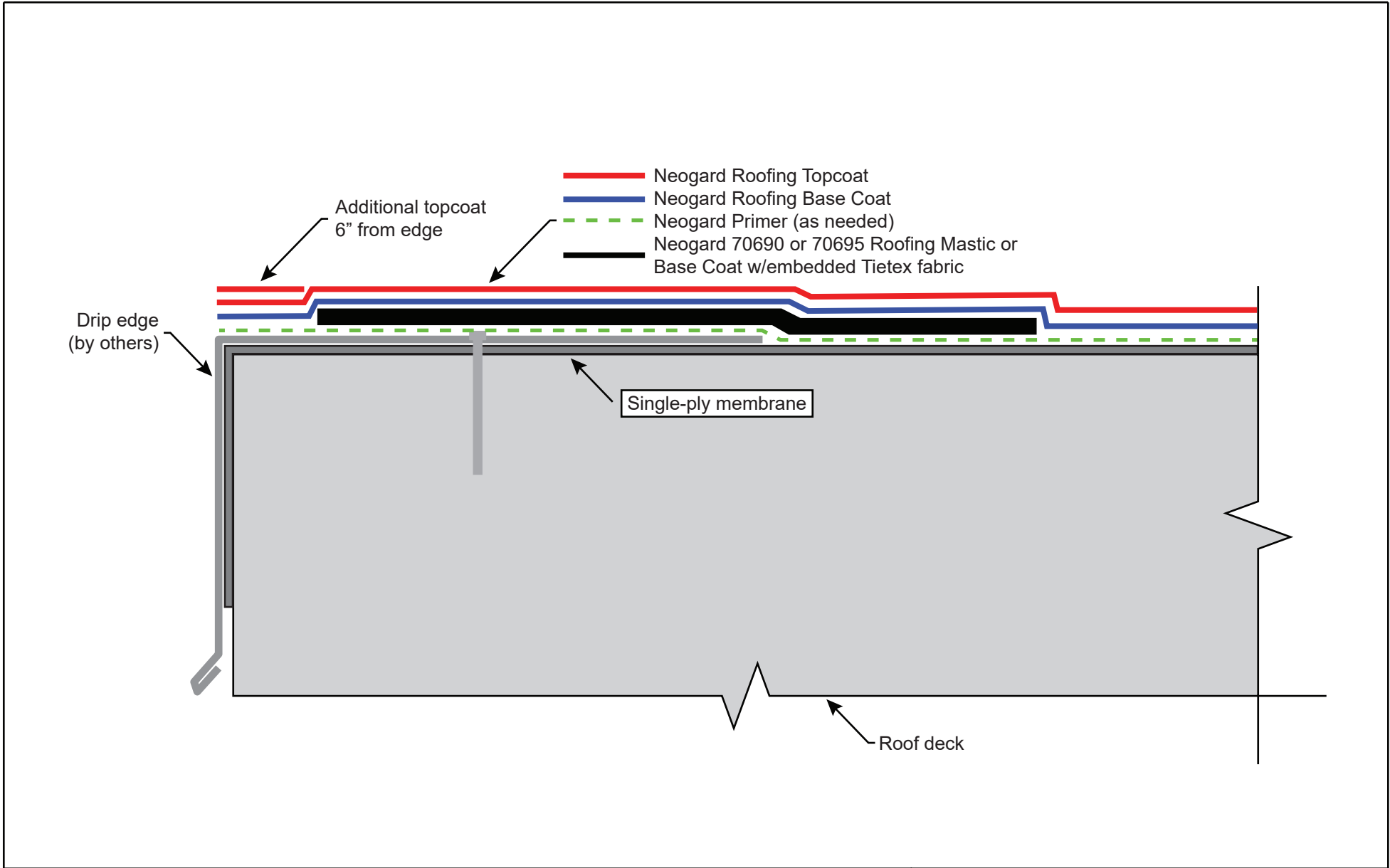

Note: This detail is utilized in the specification and design of fluid-applied roofing, in both new and retrofit applications. It is provided to show a generally recommended procedure for dealing with the condition shown. It will not and cannot provide a specific solution for every condition likely to be encountered in field application. Where field conditions differ, the use of applicable portions of the detail shown or its adaptation by an experienced and conscientious applicator should result in a quality project.



2728 Empire Central  
 Dallas, Texas 75236  
 (214)-353-1600  
 www.neogard.com

Project:  
 Edge Detail, Single-Ply Substrate

Drawn by: KSK	Scale: NTS	Date: 08/20/2021	Drawing/Index No. ROOF-SP_edge-08202021
------------------	---------------	---------------------	--

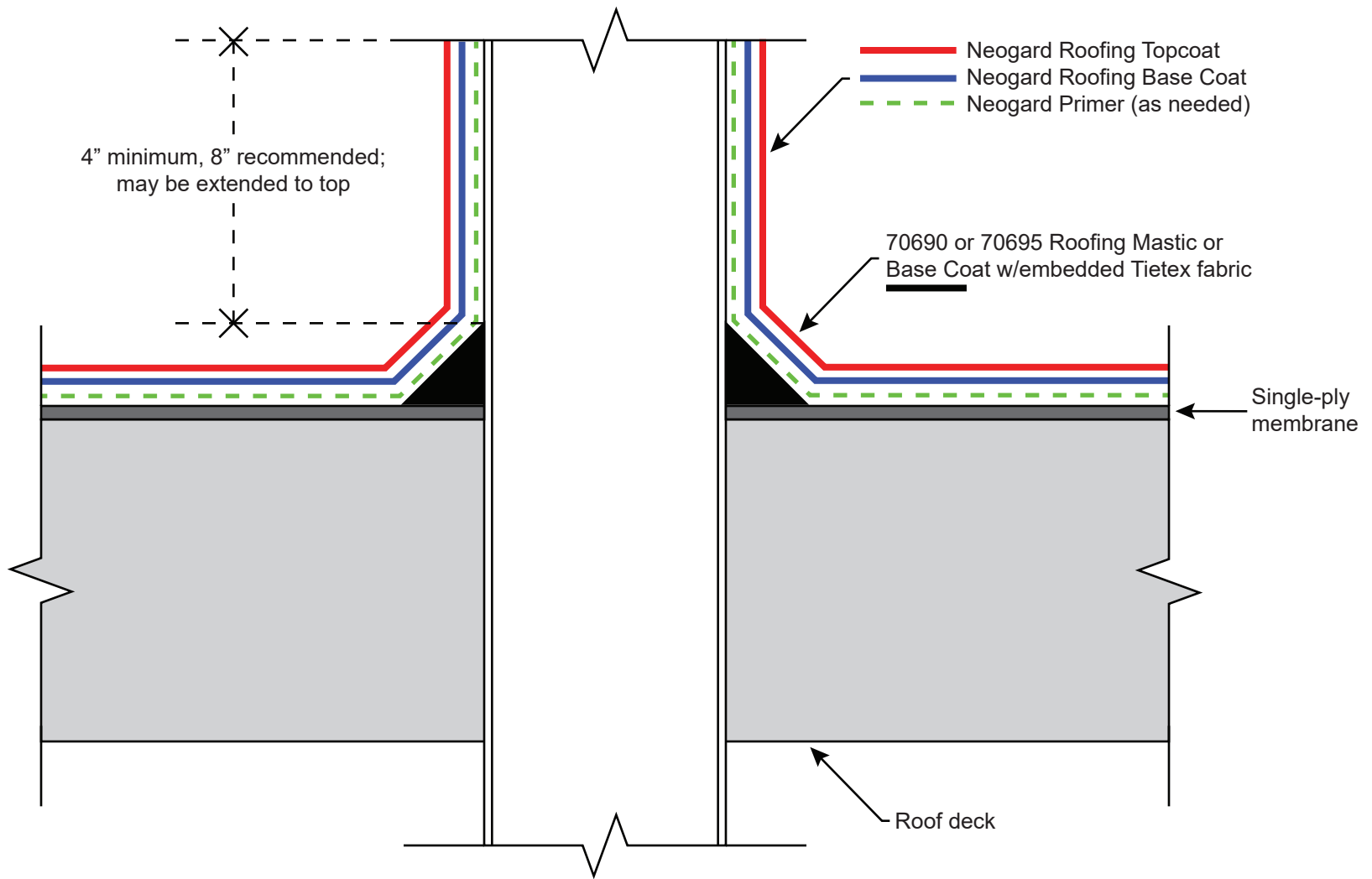

Note: This detail is utilized in the specification and design of fluid-applied roofing, in both new and retrofit applications. It is provided to show a generally recommended procedure for dealing with the condition shown. It will not and cannot provide a specific solution for every condition likely to be encountered in field application. Where field conditions differ, the use of applicable portions of the detail shown or its adaptation by an experienced and conscientious applicator should result in a quality project.



2728 Empire Central  
 Dallas, Texas 75236  
 (214)-353-1600  
 www.neogard.com

Project:  
 Pipe Penetration, Single Ply Substrate

Drawn by: KSK	Scale: NTS	Date: 08/20/2021	Drawing/Index No. ROOF-SP_pipe-08202021
------------------	---------------	---------------------	--

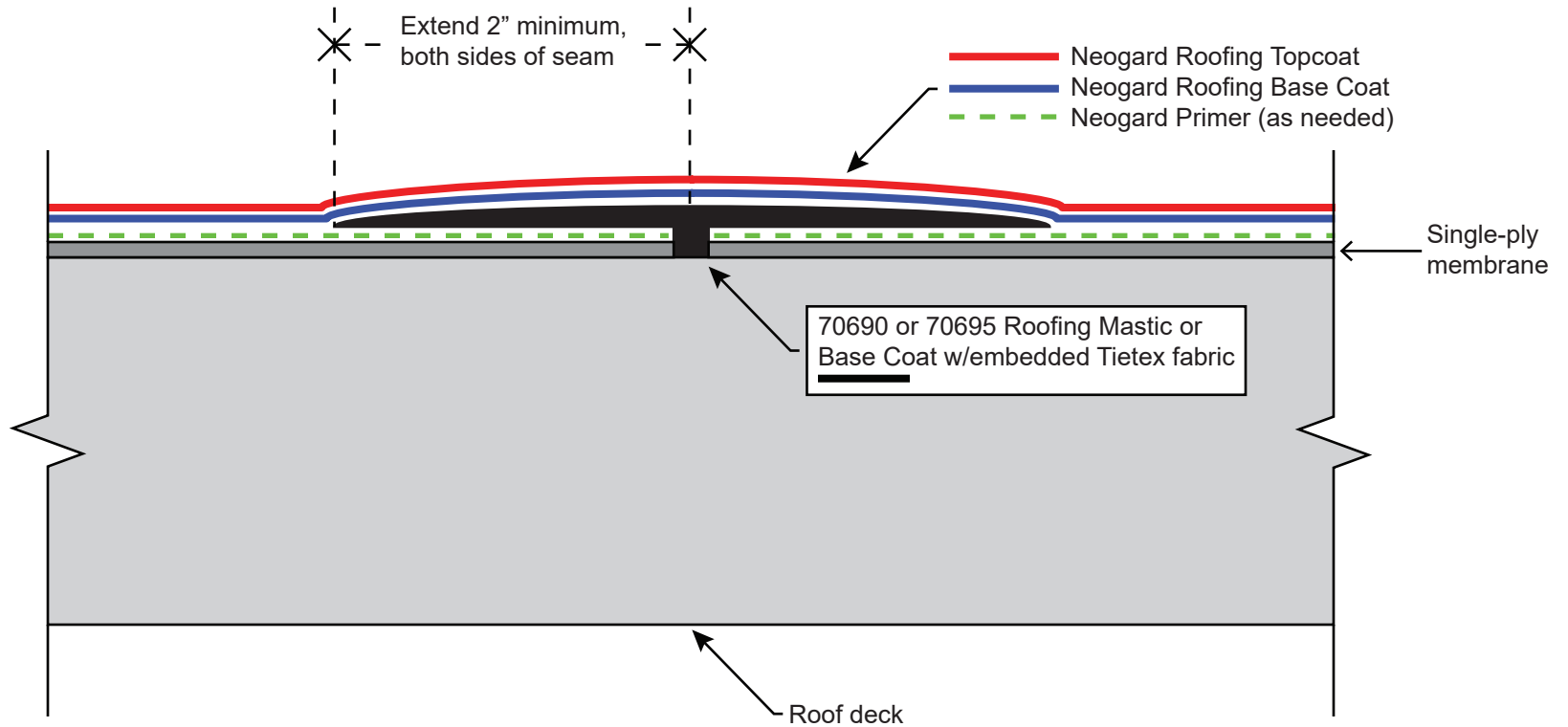

Note: This detail is utilized in the specification and design of fluid-applied roofing, in both new and retrofit applications. It is provided to show a generally recommended procedure for dealing with the condition shown. It will not and cannot provide a specific solution for every condition likely to be encountered in field application. Where field conditions differ, the use of applicable portions of the detail shown or its adaptation by an experienced and conscientious applicator should result in a quality project.



2728 Empire Central  
 Dallas, Texas 75236  
 (214)-353-1600  
 www.neogard.com

Project:  
 Seam Detail, Single Ply Substrate

Drawn by: KSK	Scale: NTS	Date: 08/20/2021	Drawing/Index No. ROOF-SP_seam-08202021
------------------	---------------	---------------------	--